

THIS INFORMATION IS CONFIDENTIAL AND PROPRIETARY TO CW INDUSTRIES INCORPORATED AND ITS AFFILIATES. IT MAY NOT BE DISCLOSED TO ANYONE, OTHER THAN CW INDUSTRIES PERSONNEL, WITHOUT WRITTEN AUTHORIZATION FROM CW INDUSTRIES INCORPORATED, SOUTHAMPTON, PENNSYLVANIA USA.

Rating	16A 125VAC 1/8HP 125VAC 10A 250VAC 1/3HP 250VAC	Mounting Hole		Circuit Diagram	
Contact Resistance	50m ohm Max.				
Insulation Resistance	DC 500V 100M ohm Min.				
Dielectric Strength	AC 1500V 1 minute				
Operation Temperature	-25°C~85°C	Thickness	X		Y
Switch Function	SEE CHART	0.75...1.25	30.2-0.1		11.2+0.1
		1.25...2	30.4-0.1	11.2+0.1	
		2...3	30.8-0.1	11.2+0.1	

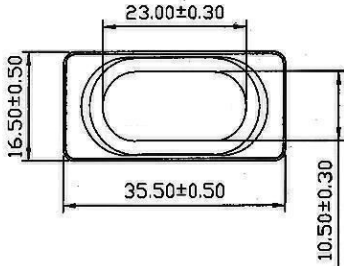

Frames: Black, Nylon 66 (94V-2)
Actuator: Black, Nylon 66 (94V-2)
Illuminated Actuators: PC, In Red, Amber or Green Colors
Terminals: # 1 & # 2 Copper alloy, Silver plated
Terminal: # 3 Brass alloy
Waterproof Rubber: Black, Silicone
Waterproof: IP65

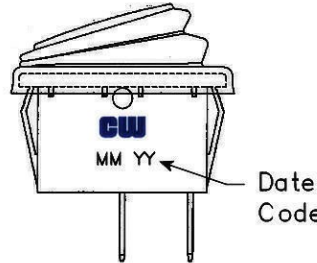
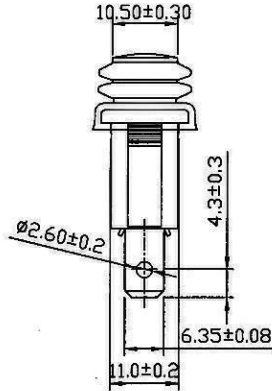
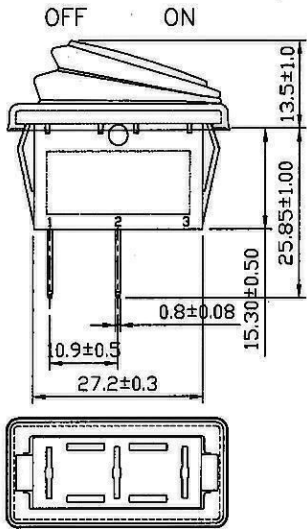

Terminal Options

0 1		.250" SQ
0 5		SO

FUNCTION

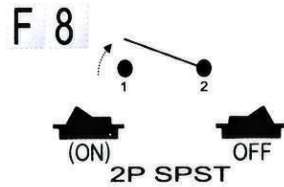
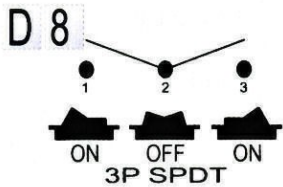
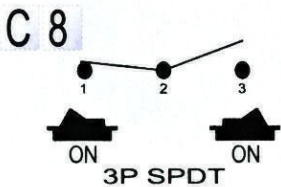
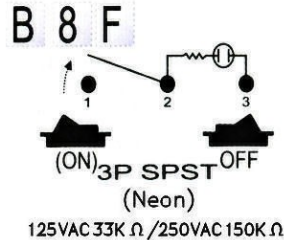
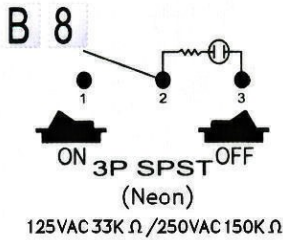
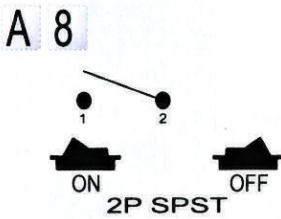

RoHS Compliant

() = Momentary Function

CW INDUSTRIES
Southampton, Pa. 18966
Tel 215.355.7080/www.cwind.com

Date Drawn: 1/21/2011

Rev. 0

Unit: mm

Checked By: G.Guld

Title: **ROCKER SWITCH**

CW P/N: **GRB070X8SERIES**